



2025 MODELS

M2XI Family Operation Manual

Model

M2XI Stainless

M2XI Black

M2XI

FROM BERSA USA



revised 05_07

bersausa.com

Disclaimers



WARNING: Bersa is not to be held liable for any loss, damage, injury, or death occurring from the use of its firearms. Full responsibility falls on the owner when using any Bersa firearms.



WARNING: Misuse or carelessness with the firearm may result in serious injury or death to the user or those in near proximity. Bersa cannot and will not be held responsible for any injury and/or death sustained due to misuse or carelessness of the user.



WARNING: Bersa firearms are not to be used with any cartridges other than the designated size round for the current chamber and that meets industry standards. Do not fire any other ammunition in your firearm. Use only clean, dry, high quality commercially manufactured ammunition. Do not fire old, corroded, deformed, damaged, remanufactured, or handloaded ammunition. Neglecting to do so may result in serious injury and/or death.

Break-In Period

The Bersa M2XI are custom firearms, hand lapped, hand fitted, and manufactured with extremely tight tolerances by experienced craftsman. The M2XI firearm requires that you field strip and clean the firearm, following the procedures provided. Please refer to the disassembly, cleaning, and lubrication instructions in this manual. To assist the frame, slide, and barrel lock-up to marry and break-in together, there is a process for properly breaking-in the firearm. The M2XI will need to be fired about 400 to 500 rounds with quality FMJ ammunition, cleaning and lubricating the gun every 100 rounds.

NOTICE CONCERNING SOME FLAT-NOSE AND HOLLOW POINT AMMUNITIONS

In rare occurrence, the M2XI firearm may not feed some flat nose and some hollow point ammunitions. Bersa has made minor modifications in the historic M2XI Series 70 design to improve the feed success of many flat nose and hollow point ammunitions; still, some aggressive variations of flat nose and hollow point ammunitions can present feed problems. Bersa suggest testing ammunition for proper feeding prior to relying on any ammunition for any situations where steadfast reliability is required.

NOTE:

This Table of Contents is provided for convenient reference. Please refrain from using it to skip any portion of this manual until you have thoroughly reviewed the entire Operation Manual and are fully familiar, proficient, and practiced with all the information it contains.

Table of Contents

Disclaimers	4
Rules for Safe Operation	8
Nomenclature / Locking Devices	11
Operation of Safety	16
Loading & Firing	18
Unloading	23
Malfunctions	26
Disassembly / Reassembly	28
Care & Cleaning	36
Lubrication	38
Service & Parts	40
Firearm Guarantee	41
Disclaimer of Liability	42

STATE-BY-STATE WARNINGS:

Certain states require by law that their own specified warning notices in larger-than-normal type be conspicuously included by the manufacturer, distributor or retailer with firearms sold in that state.

BERSA sells its products in compliance with applicable laws and regulations. Because our products may be sold in these states, we include the following:



WARNING:

Firearms must be handled responsibly and securely stored to prevent access by children and other unauthorized users. California has strict laws pertaining to firearms, and you may be fined or imprisoned if you fail to comply with them. Visit the Web site of the California Attorney General at <https://oag.ca.gov/firearms> for information on firearm laws applicable to you and how you can comply.

Prevent child access by always keeping guns locked away and unloaded when not in use.

If you keep a loaded firearm where a child obtains and improperly uses it, you may be fined or sent to prison. If you or someone you know is contemplating suicide, please call the national suicide prevention lifeline at 1-800-273-TALK (8255).



ADVERTENCIA

Las armas de fuego deben manipularse de manera responsable y segura para evitar el acceso de niños y otros usuarios no autorizados. California tiene leyes estrictas relacionadas con armas de fuego, y usted puede ser multado o encarcelado si no las cumple. Visite el sitio web del Procurador General de California en <https://oag.ca.gov/firearms> para obtener información sobre las leyes de armas de fuego que le son aplicables y cómo puede cumplirlas.

A los niños los atraen las armas de fuego y las pueden hacer funcionar. Ellos pueden causarse lesiones graves y la muerte. Evite que los niños tengan acceso a las armas de fuego guardándolas siempre con llave y descargadas cuando no las esté utilizando. Si usted tiene un arma de fuego cargada en un lugar en que un niño tiene acceso a ella y la usa indebidamente, le pueden dar una multa o enviarlo a la cárcel.

Si usted o alguien que conoce está pensando en suicidarse, llame a la línea nacional de prevención del suicidio al 1-800-273-TALK (8255).

Connecticut:

“UNLAWFUL STORAGE OF A LOADED FIREARM MAY RESULT IN IMPRISONMENT OR FINE.”

Florida:

“IT IS UNLAWFUL, AND PUNISHABLE BY IMPRISONMENT AND FINE, FOR ANY ADULT TO STORE OR LEAVE A FIREARM IN ANY PLACE WITHIN THE REACH OR EASY ACCESS OF A MINOR UNDER 18 YEARS OF AGE OR TO KNOWINGLY SELL OR OTHERWISE TRANSFER OWNERSHIP OR POSSESSION OF A FIREARM TO A MINOR OR A PERSON OF UNSOUND MIND.”

Maine:

“ENDANGERING THE WELFARE OF A CHILD IS A CRIME. IF YOU LEAVE A FIREARM AND AMMUNITION WITHIN EASY ACCESS OF A CHILD, YOU MAY BE SUBJECT TO FINE, IMPRISONMENT OR BOTH. KEEP FIREARMS AND AMMUNITION SEPARATE. KEEP FIREARMS AND AMMUNITION LOCKED UP. USE TRIGGER LOCKS.”

Maryland:

“WARNING: Children can operate firearms which may cause death or serious injury. It is a crime to store or leave a loaded firearm in any location where an individual knew or should have known that an unsupervised minor would gain access to the firearm. Store your firearm responsibly!”

Massachusetts:

“WARNING FROM THE MASSACHUSETTS ATTORNEY GENERAL: This handgun is not equipped with a device that fully blocks use by unauthorized users. More than 200,000 firearms like this one are stolen from their owners every year in the United States. In addition, there are more than a thousand suicides each year by younger children and teenagers who get access to firearms. Hundreds more die from accidental discharge. It is likely that many more children sustain serious wounds, or inflict such wounds accidentally on others. In order to limit the chance of such misuse, it is imperative that you keep this weapon locked in a secure place and take other steps necessary to limit the possibility of theft or accident. Failure to take reasonable preventive steps may result in innocent lives being lost, and in some circumstances may result in your liability for these deaths.”

“IT IS UNLAWFUL TO STORE OR KEEP A FIREARM, RIFLE, SHOTGUN OR MACHINE GUN IN ANY PLACE UNLESS THAT WEAPON IS EQUIPPED WITH A TAMPER RESISTANT SAFETY DEVICE OR IS STORED OR KEPT IN A SECURELY LOCKED CONTAINER.”

New Jersey:

“IT IS A CRIMINAL OFFENSE TO LEAVE A LOADED FIREARM WITHIN EASY ACCESS OF A MINOR.”

New York:

“THE USE OF A LOCKING DEVICE OR SAFETY LOCK IS ONLY ONE ASPECT OF RESPONSIBLE FIREARM STORAGE. FOR INCREASED SAFETY, FIREARMS SHOULD BE STORED UNLOADED AND LOCKED IN A LOCATION THAT IS BOTH SEPARATE FROM THEIR AMMUNITION AND INACCESSIBLE TO CHILDREN AND UNAUTHORIZED PERSONS.”

North Carolina:

“IT IS UNLAWFUL TO STORE OR LEAVE A FIREARM THAT CAN BE DISCHARGED IN A MANNER THAT A REASONABLE PERSON SHOULD KNOW IS ACCESSIBLE TO A MINOR.”

Texas:

“IT IS UNLAWFUL TO STORE, TRANSPORT, OR ABANDON AN UNSECURED FIREARM IN A PLACE WHERE CHILDREN ARE LIKELY TO BE AND CAN OBTAIN ACCESS TO THE FIREARM.”

Wisconsin:

“IF YOU LEAVE A LOADED FIREARM WITHIN THE REACH OR EASY ACCESS OF A CHILD YOU MAY BE FINED OR IMPRISONED OR BOTH IF THE CHILD IMPROPERLY DISCHARGES, POSSESSES, OR EXHIBITS THE FIREARM.”

* * * * *

Please check with your licensed retailer or state police for additional warnings which may be required by local law or regulation. Such regulations change constantly, and local authorities are in the best position to advise you on such legal matters.

FIREARMS SAFETY IS YOUR RESPONSIBILITY

SAFETY MUST BE THE FIRST AND CONSTANT CONSIDERATION OF EVERY PERSON WHO HANDLES FIREARMS AND AMMUNITION.

This instruction manual serves to assist you in learning proper use and care of your Bersa M2XI pistol. Please contact us if you have any questions.

Only once you are certain you fully understand the manual and can properly carry out instructions while the pistol is unloaded should you practice operations with live ammunition. Should you have any doubts about your handling or use of the firearm in a safe manner, you should seek supervised instruction. Such instruction is often available from local firearm retailers, gun clubs or ranges, or local police departments. If none of these sources can help, visit nssf.org/safety/ or write to the following address:

National Shooting Sports Foundation

6 Corporate Drive, Suite 650

Shelton, CT 06484

Possessing a firearm is a full-time responsibility. Never guess and never forget. You must know safe use of your firearm. Do not use any firearm without a complete understanding of its unique characteristics and safe use. Remember: There is no such thing as a foolproof firearm.

The Four Primary Rules of Firearm Safety

1. Always keep any firearm pointed in a safe direction.
2. Treat all guns as though they are loaded.
3. Keep your finger off the trigger and outside the trigger guard until you are ready to shoot.
4. Always be sure of your target and what is beyond it.

NOTICE:

BERSA ask that you please take a moment and register the purchase of your firearm. Registration will assist in any warranty claims.

Register directly at:

(833) 476-1547

or visit our Warranty/Registration page at:

<https://bersausa.com/warranty/>

NOTICE:

If you encounter any problems with your BERSA firearm, please contact BERSA directly at:

(833) 476-1547

or visit our Warranty / Registration page at:

<https://bersausa.com/warranty/>

Bersa

Cartersville, Georgia

(833)476-1547

www.Bersausa.com

Nomenclature

Standard Model Shown – Not All Models Contain all of These Features

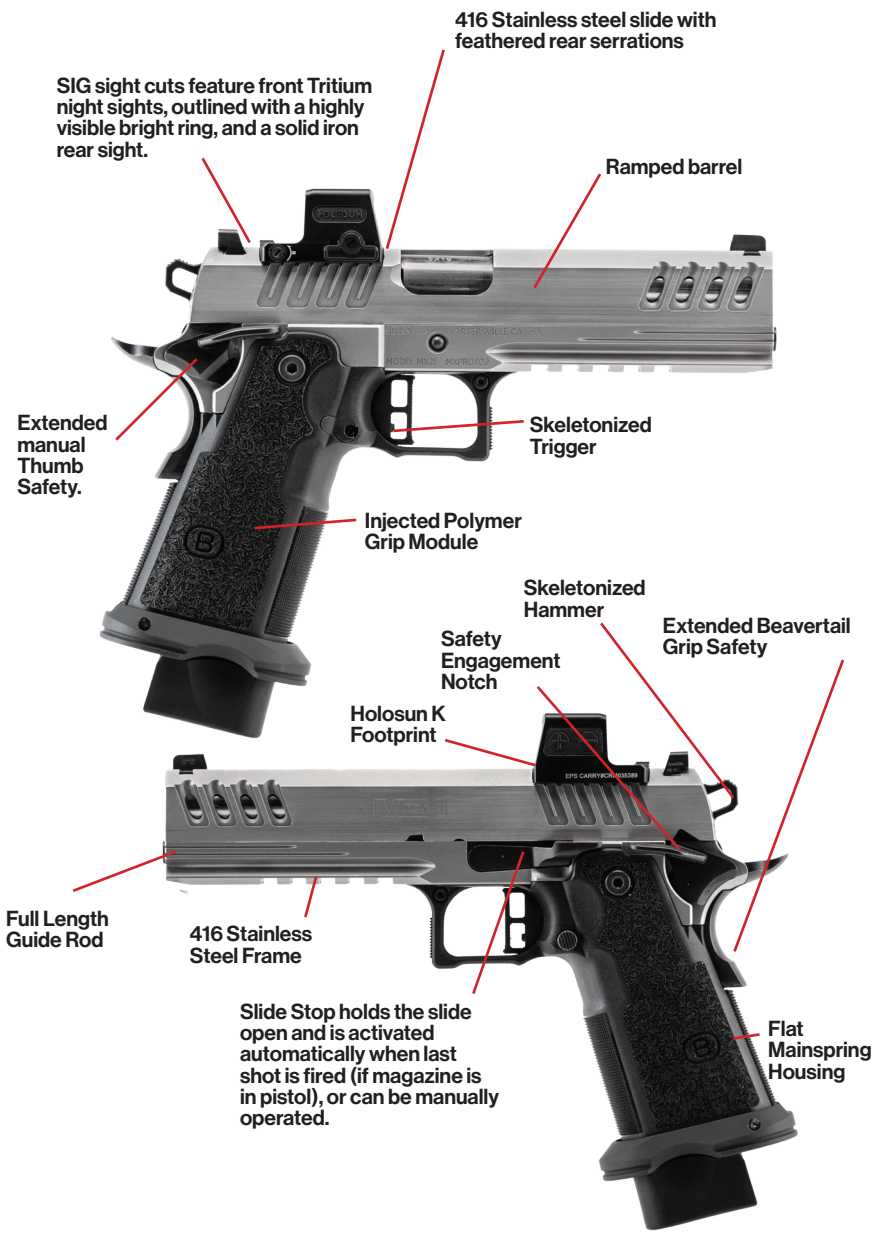



WARNING – USE OF LOCKING DEVICES

Always keep your firearm pointed in a safe direction, including when you are installing or removing your locking device.

- Always ensure firearm is pointed in a safe direction, even when installing or removing your locking device.
- Before installing the locking device, always confirm that the firearm is completely unloaded.
- Avoid placing locking devices inside the trigger guard. Keep fingers and locking device outside of trigger guard during installation and removal.
- Store firearms, ammunition, and keys separately and securely, out of reach of children and careless adults. Do not keep keys inside locking device when storing firearm.
- Refrain from operating the action of your firearm with the locking device in place, as it may cause damage.
- While locking devices enhance security, they do not replace proper firearm handling and storage practices. Remember that any mechanical device can be circumvented with sufficient time, knowledge, determination, and equipment.

LOCKING DEVICES MUST BE USED SAFELY AND RESPONSIBLY

Use of the locking device on your Bersa firearm is important when stored or otherwise not in use.

Keep the muzzle pointed in a safe direction and your fingers outside the trigger guard at all times during installation of the locking device!

To Install the Locking Device:

1. Remove magazine from the pistol.
2. Completely open action and verify firearm is completely unloaded and contains no cartridge or casings.
3. Use the slide stop to keep the action open during installation of the locking device.

4. As shown in Figure 1, insert the cable directly into your pistol.
5. With the key in the furthest clockwise position, insert loose end of cable into lock. Turn the key counterclockwise and remove it from lock.
6. Once lock is securely closed, pull firmly on the lock to ensure complete security and locking. Do not leave or store your firearm with the key in the lock! Store your locked, unloaded firearm and the key in secure, separate locations, away from ammunition, children, and unauthorized adults.



Correct installation of the lock on a M2XI pistol.

**FIREARMS ARE DANGEROUS WEAPONS.
READ THE INSTRUCTIONS AND WARNINGS
IN THIS MANUAL THOROUGHLY AND
CAREFULLY BEFORE USE.**



WARNING - ALTERATIONS



This product was designed to function properly in its original condition. Alterations can make it unsafe. Do not alter any part or add or substitute parts or accessories not made or sold by Bersa Inc.

DO NOT ALTER ANY FIREARM

GENERAL INFORMATION AND MECHANICAL CHARACTERISTICS

The M2XI pistol lacks a firing pin block, often referred to as a “Series 70” design. Additional safety features include a beavertail-style grip safety and an extended thumb safety for easier toggling in all conditions. A visual inspection port allows for easy checking of the chamber’s status for loaded rounds.

Our M2XI pistol offers three hammer positions: “AT REST” (fully forward), “FULLY COCKED” (fully rearward), and “HALF-COCKED”.

In the “AT REST” position, the hammer rests on the firing pin. It’s important to note that the pistol should never be carried or left in the “AT REST” position with a round chambered. It should only be in this position when the chamber is empty.

The “FULLY COCKED” position, when the hammer is pulled all the way back to the second click point, signifies the fire-ready state. Pulling the trigger in this position will discharge the pistol if loaded. When carrying the pistol in the FULLY COCKED position, it’s essential to engage the manual safety as an added precaution.

The “HALF-COCKED” hammer position acts as an automatic safety mechanism, activated in the event of an unintentional hammer fall, and should not be utilized during regular operation. If the hammer is inadvertently released beyond this point, it will settle into the HALF-COCKED position, preventing contact with the firing pin. Intentionally placing the hammer in this position is

not recommended as it is not a manual safety feature and should not be treated as such.

Firing the pistol from the half-cocked position is never advised. To disengage the hammer from the half-cocked position, ensure the firearm is pointed in a safe direction. With your finger off the trigger and outside the trigger guard, pull the hammer all the way back to the fully cocked position. At this point, the pistol is ready to fire if desired. Alternatively, if firing is not intended, fully unload the pistol by removing the magazine and clearing the chamber. Once fully unloaded and verified, while pointing the pistol in a safe direction, carefully hold the hammer while pulling the trigger and slowly let it down to the at rest position.

The M2XI pistol incorporates several important features that users should thoroughly understand:

Action: The action of the M2XI pistol employs a tilting barrel design. During firing, the barrel and slide are securely locked together. Upon firing, both the



THE PISTOL SHOULD NEVER BE CARRIED OR LEFT AT REST ON A LOADED CHAMBER. IT SHOULD ONLY BE CARRIED AT REST ON AN EMPTY CHAMBER. IF CARRYING THE PISTOL IN THE FULLY COCKED POSITION THE MANUAL SAFETY SHOULD ALWAYS BE ENGAGED. NEVER CARRY THE PISTOL IN THE HALF-COCKED POSITION.

barrel and slide recoil back together briefly while remaining locked then the barrel tilts downward and becomes disengaged from the slide, allowing for the full recoil of the slide and the extraction of the spent cartridge. As the slide returns forward, driven by the recoil spring, the barrel re-engages and locks back into position.

It's crucial for users of this or any autoloading pistol to always bear in mind that upon firing, it automatically reloads and readies itself for the next shot. Therefore, users must remain aware and keep the pistol pointed in a safe direction at all times.

Slide Stop: The slide stop serves multiple functions in the operation of the pistol:

Automatic Locking: When the last round is fired and the magazine is empty, the slide stop automatically engages, holding the slide open. Similarly, if the slide is manually retracted with an empty magazine in place, the slide stop will also engage, keeping the slide open. However, if a loaded magazine is inserted

with the slide closed and then the slide is fully pulled back, the slide stop will not engage automatically.

Manual Activation: The user can manually activate the slide stop to hold the slide open at any time by pulling back the slide and pushing the slide stop upwards.

Release Mechanism: When no magazine is present, or a loaded magazine is inserted, the slide stop can be disengaged by pulling back slightly on the slide and then releasing it. Alternatively, when an empty magazine is inserted, the slide stop can be released by pulling back slightly on the slide, depressing the slide stop thumb piece, and then releasing the slide.

Safety Precautions: If the pistol is jarred while a loaded magazine is in place, the slide can unexpectedly fly forward and chamber a cartridge. To mitigate this risk, users should always keep their fingers away from the trigger and ensure the pistol is pointed in a safe direction at all times.

Magazines: The magazines designed for the M2XI pistol are specific to its caliber and model. Even though magazines for other Bersa or M2XI pistols may appear similar and may hold different cartridges, they are not interchangeable.

It is crucial to use only magazines provided by Bersa, which are designed and manufactured to Bersa specifications, specifically for your firearm. Using incorrect magazines in any pistol can lead to malfunctions.

Overtravel Trigger Adjustment: Overtravel refers to the distance the trigger moves backward after the sear disengages from the sear notch of the hammer. The overtravel of each M2XI pistol trigger is preset at the factory. Insufficient overtravel can cause the sear to fail to disengage the hammer fully, leading to the hammer dropping to the half-cock notch. This condition can prevent the pistol from firing and cause damage to both the hammer and sear. Therefore, we do not recommend adjusting the overtravel of the M2XI pistol trigger, and no adjustment tool is provided with the pistol.

Operation Of Manual Safety

The M2XI pistol is furnished with a manual thumb safety, and it's imperative to familiarize yourself with its operation.

When the safety lever is fully lowered, as depicted in Figure 2 (observing NO interaction between the safety lever and Safety Engagement Notch), the pistol is in the “fire” position. Conversely, when the safety lever is fully raised, as illustrated in Figure 3 (noting COMPLETE engagement between the safety lever and Safety Engagement Notch), the pistol is in the “safe” position.

The manual safety lever can only enter the “safe” position when the hammer is fully cocked.



Figure 2. Safety Down - Safety Off



Figure 3. Safety Up - Safety On



WARNING - MANUAL SAFETY



Placing the safety in an intermediate position between “safe” and “fire” can result in the user thinking the pistol is in a safe or fire position when it is not. Pulling the trigger with the safety in an intermediate position may cause the pistol to fire.

Therefore, always move the safety fully to its intended position and then check to be sure it is where you want it to be.



NEVER PUT SAFETY 1/2 ON



WARNING –SAFETY

Hammer Cocked, Safety On



To place the safety in the fully up (“safe”) position, the slide must be forward and the hammer must be in the fully cocked position. Attempting to place the safety in the up position while the hammer is not fully cocked will allow only partial movement of the lever and will not engage the safety. Always make sure the manual safety lever is properly engaged.



**HAMMER MUST BE FULLY COCKED
TO ENGAGE SAFETY**

Ammunition

The M2XI pistols are compatible with all factory ammunition of the correct caliber loaded to U.S. Industry Standards, including high-velocity and hollow-point loads, loaded in brass, aluminum, or steel cartridge cases. No ammunition manufactured in accordance with NATO, U.S., SAAMI, or CIP standards is known to not function in these pistols.

Be certain to use the correct caliber for your pistol, and do not attempt to load any other caliber or cartridge into the magazine or chamber of the pistol.



WARNING –AMMUNITION



Use only new, factory ammunition of the correct caliber. Death, serious injury, and damage can result from the wrong ammunition, bore obstructions, powder overloads or incorrect cartridge components.

Always wear shooting glasses and hearing protection.



**IMPROPER AMMUNITION
DESTROYS FIREARMS**

AMMUNITION (CARTRIDGES) NOTICE

WE SPECIFICALLY DISCLAIM RESPONSIBILITY FOR ANY DAMAGE OR INJURY WHATSOEVER OCCURRING IN CONNECTION WITH, OR AS THE RESULT OF, THE USE IN BERSA PISTOLS OF FAULTY, OR NONSTANDARD OR "REMANUFACTURED" OR HANDLOADED (RELOADED) AMMUNITION OR OF CARTRIDGES OTHER THAN THOSE FOR WHICH THE FIREARM WAS ORIGINALLY CHAMBERED.



WARNING - LEAD EXPOSURE



Discharging firearms in poorly ventilated areas, cleaning firearms, or handling ammunition may result in exposure to lead and other substances known to the State of California to cause birth defects, reproductive harm, and other serious physical injury. Have adequate ventilation at all times. Wash hands thoroughly after exposure.



**SHOOTING OR CLEANING FIREARMS
MAY EXPOSE YOU TO LEAD**

To Load And Fire

Ensure that you practice every aspect of safe firearm handling, including these specific steps, with an unloaded pistol until you can proficiently and confidently execute each skill. It's crucial to familiarize yourself thoroughly with this manual before engaging in any activity involving the pistol.

1. Be certain the muzzle is pointed in a safe direction at all times.
2. Press the magazine catch inward from the left side to release and completely remove the magazine. Please note: The magazine is engineered to drop freely from the frame under specific conditions—when unloaded, with the slide locked open, and the pistol held in the regular firing position. However, it's advised against allowing it to fall to the ground unless absolutely necessary so as to prevent potential damage to the magazine.
3. Load the magazine with no more than the maximum number of cartridges designated.

4. Insert the magazine fully and ensure the magazine catch engages.
5. Hold pistol firmly in firing hand, keeping finger free of trigger and trigger guard.
6. Keeping the pistol pointed in a safe direction, with the opposite hand, grasp the rear of the slide and pull the slide back completely. Once the slide is pulled all the way back, release the slide. The slide will fly forward and chamber the top round from the magazine.

WARNING: The pistol is ready for instant use once the slide moves forward if the safety is in the “fire” position. Be careful and follow all the rules of firearm safety, keeping your finger off the trigger and outside the trigger guard!

7. The manual safety should be immediately placed in the “safe” position. If the pistol is to be fired immediately, the manual safety lever can be moved back to the fire position once you have insured there is nothing beyond the target that would present any type of hazard, insure your finger is not on trigger or inside trigger guard, and the gun is on the intended target.



8. The pistol is ready for use when the safety is disengaged. Use extreme caution and always practice all rules of firearm safety. At this point, depressing of the trigger will discharge the pistol. Subsequent shots are fired single-action until the magazine is empty, the hammer being cocked by recoils of each shot.
9. If no further shots are intended and the magazine is not empty, fully engage the safety to the “safe” position while ensuring the muzzle is continuously pointed in a safe direction.
10. When the last cartridge from the magazine has been fired, the magazine follower presses the slide stop upward to automatically hold the slide back

and keep the action open. If the slide is shut, the shooter should always assume that there is a cartridge in the chamber until able to safely verify its condition.

Never assume a firearm is empty or rely on memory. All firearms should be assumed loaded until a visual inspection of the chamber and magazine can be performed.



WARNING - SLIDE RETRACTION



The slide should always be pulled rearward ("retracted") by pulling the rear portion of the slide in the vicinity of the serrations. **Always keep fingers away from trigger!**

Never put any part of your hands or body over the muzzle while retracting the slide for loading, unloading, inspection, or clearing a malfunction.



KEEP HANDS AWAY FROM MUZZLE AND FINGER OFF THE TRIGGER WHEN RETRACTING THE SLIDE



WARNING - FIRING



The slide automatically opens and shuts quickly while firing. Keep face and hands away from rear. Hot brass is ejected quickly and can burn you. Hot brass is ejected quickly and can burn you. Always wear shooting glasses, hearing protection, and avoid loose clothing, open collars, open blouses, and open toed shoes.



SLIDE OPENS FAST - HOT BRASS EJECTED

Visual Inspection Port

Always regard every firearm as if it were loaded and maintain safe muzzle direction at all times. Do not depend on safety features or mechanical devices to excuse unsafe or careless firearm handling. To aid in detecting the presence of a cartridge in the chamber of your M2XI pistol, it is outfitted with a visual inspection port situated at the top of the slide, or ejection port. To check for the presence of a cartridge in the chamber, carefully peer into the visual inspection port while pulling the slide back enough to see in the chamber.



Visual Inspection Port



NEVER RELY ON YOUR MEMORY TO KNOW IF A FIREARM IS LOADED. ALWAYS VISUALLY CHECK THE CHAMBER BY RETRACTING THE SLIDE AND EXAMINING THE CHAMBER TO BE SURE WHETHER IT IS EMPTY OR LOADED.



WARNING - HANDLING



Never rely on any mechanical device to justify careless handling or allowing the pistol to point in an unsafe direction. The shooter must remain vigilant regarding the potential for accidental discharge. Any firearm is capable of firing if dropped or struck. The only truly safe pistol is one with the slide open, the chamber empty, and no magazine inserted.

If choosing to carry a pistol with a cartridge

in the chamber, it should be securely stored in a properly fitting holster that fully covers the trigger guard. Safely holstering and drawing a firearm requires careful attention to firearms safety: Keep your fingers away from the trigger and outside the trigger guard, always maintain the muzzle in a safe direction, and never positioning any part of your body in front of the muzzle. These practices should be rehearsed with an unloaded firearm until you attain the skills and confidence to perform them consistently and reliably.



ANY FIREARM MAY FIRE IF DROPPED

Dry Firing

Practicing the sequence of cocking, aiming, and pulling the trigger on an unloaded firearm is commonly referred to as “dry firing.” This exercise can help familiarize you with the handling characteristics of your pistol. It’s crucial to ensure the pistol is completely unloaded, with both the chamber and magazine empty, and that it is pointed in a safe direction at all times during dry firing practice. The M2XI pistols are designed to withstand dry firing without causing damage to the firing pin or other components.

To Unload

WARNING: Carefully follow all instructions in the specified order. Failure to do so could result in damage or a live round being chambered mistakenly.



WARNING - UNLOADING



Removing magazine does not unload pistol!
To unload, first remove magazine, then pull slide to rear, eject chambered cartridge, and visually inspect chamber to be sure it is empty. Always point the pistol in a safe direction when loading or unloading.



REMOVING MAGAZINE DOES NOT UNLOAD CHAMBER

1. Keep the pistol's muzzle pointed in a safe direction at all times, and ensure fingers remain outside of the trigger guard. Confirm that the hammer is fully cocked and engage the safety lever to its "safe" position.
2. Press the magazine catch to remove the magazine from the pistol. Remember, even after removing the magazine, a live round may still be chambered, and the pistol can discharge without the magazine. (Refer to "Warning - Unloading" above.)
3. With fingers off the trigger and outside the trigger guard, move the safety lever to the down or "fire" position.
4. With the pistol's muzzle directed safely and fingers outside the trigger guard, firmly grip the pistol and grasp the slide. Pull the slide back briskly to its rearmost position to extract and eject any chambered cartridge. Always visually confirm that the chamber, and interior of the frame are clear of live rounds. Once the slide is fully retracted, push upward on the slide stop, then allow the slide to move forward until it rests, with the rear projection of the slide stop positioned in the notch on the lower left side of the slide.
5. To close the slide, once again verify that the chamber is empty, and that the magazine is still removed from the pistol. While ensuring fingers are kept clear of the ejection port on top of the slide, pull the slide to its rearmost position and release it. The slide will snap forward.

6. While firmly holding on to hammer, depress the trigger and lower the hammer safely.
7. To unload any cartridges from the magazine that was removed in Step 2, remove them by sliding each cartridge forward and out of the magazine, one at a time, until the magazine is empty.
8. Insert the empty, unloaded magazine into the frame until the magazine catch locks it in place.

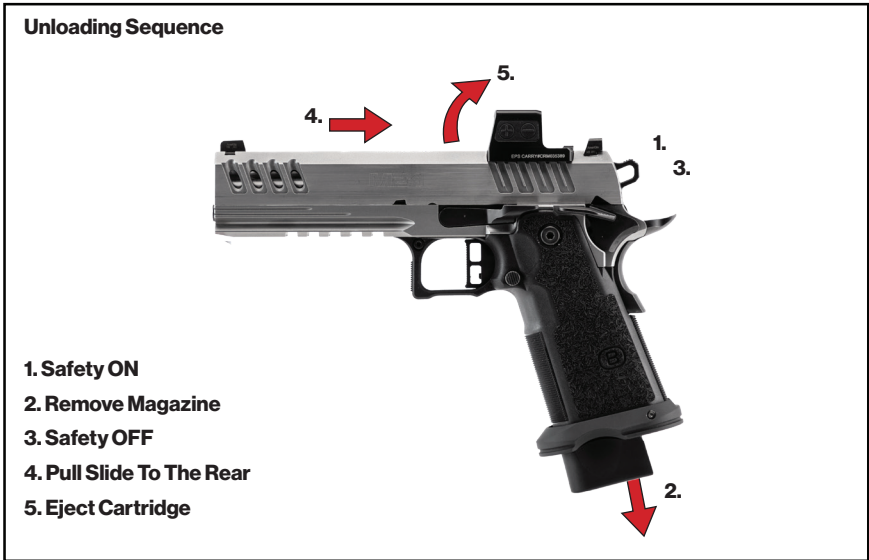

To Reload The Pistol

1. Discharging all cartridges in the magazine and chamber will cause the slide to automatically lock open. Keep the pistol directed in a safe direction. Use your thumb or forefinger to depress the magazine catch. If the slide is locked open, the magazine will detach from the pistol under its own weight. To prevent potential damage to the magazine, refrain from allowing it to fall to the ground unless rapid reloading is absolutely necessary.
2. Insert a loaded magazine. CAUTION: The slide stop is held in position by the rearward pressure from the slide. Therefore, with a loaded magazine in place, jarring the pistol may cause the slide to fly forward and chamber a cartridge.
3. Release the slide by pulling it fully to the rear and then releasing it. A cartridge will be chambered as the slide closes. CAUTION: Once the manual

safety is disengaged, the pistol is ready to fire.

4. If immediate firing is not intended, move the manual safety lever fully upward to the “safe” position. Keep the safety engaged at all times except when actively firing. After completing firing, ensure the pistol is completely unloaded, carefully following the steps from “To Unload” on page 23.

To Extract And Eject A Chambered Cartridge

When the pistol is discharged, the gas pressure that propels the bullet forward also acts on the cartridge case, driving the slide rearward. This action facilitates the extraction and ejection of the fired cartridge case. Should the shooter desire to manually eject a chambered cartridge, they should follow the “To Unload” procedure. However, when the slide is manually operated, there may be instances of failure to extract the cartridge from the chamber or failure to eject the cartridge clear of the pistol. Typically, these failures occur due to insufficient force applied to pull the slide rearward.

To mitigate these issues, firearm users must:

1. Always visually inspect the chamber and breech-face after retracting the slide to eject a chambered cartridge. Failure to vigorously retract the slide by hand may result in the extracted cartridge being “ejected” into the magazine well of the grip frame or remaining held to the breech-face by the extractor.
2. Regularly clean the chamber and extractor as needed to ensure optimal performance.

If an empty magazine is present in the pistol while manually retracting the slide to extract a cartridge, the cartridge may fall onto the top of the magazine or remain held to the breech face by the extractor. Subsequently, when the slide moves forward, the cartridge may be chambered again. It is essential to remember always to remove the magazine before clearing the chamber and visually confirm that no cartridges remain anywhere in the firearm.

To Clear A Malfunction (“Jam” Or “Misfire”)

1. Be certain the muzzle is continually pointed in a safe direction and that the safety lever is in the “safe” position.
2. If the misfire is the result of a cartridge not firing or unusual report (either louder or quieter than normal), keep the pistol pointed in a safe direction for

- 30 seconds prior to ejecting the chambered round or retracting the slide.
3. If feasible, remove the magazine. In cases where a jammed cartridge has only been partially stripped from the magazine, it may be necessary to manually extract it with extreme caution. Before attempting to clear the jam, lock the slide open using the slide stop. Pulling the slide fully to the rear may dislodge the jammed cartridge, so keep your face away from the ejection port during this process. Use only wooden tools to avoid damaging the cartridge or accidentally igniting the primer. Carefully extract the jammed cartridge from the chamber and dispose of it properly.
 4. Conduct a visual inspection to ensure all cartridges have been removed from the pistol. Dispose of any cartridges involved in a malfunction incident safely. Avoid using damaged ammunition in any firearm.
 5. Using a cleaning rod, inspect the bore and chamber of the barrel to ensure that they are not obstructed. Failure to detect and correctly remove a bore obstruction can result in serious injury.

Using a cleaning rod, inspect the bore and chamber to ensure that they are not obstructed. Failure to detect and correctly remove a bore obstruction can result in serious injury!



WARNING - MALFUNCTIONS



Any autoloading pistol may occasionally malfunction. If a cartridge hangs up, jams, or binds when being chambered, do not attempt to force it into the chamber by pushing or striking the slide. Carefully remove it.



Most failures of a cartridge to feed or to chamber properly are caused by a damaged magazine, incorrect firearm handling, insufficient lubrication, or improper ammunition.

Whatever the cause, the user of the pistol must, above all, recognize that any cartridge jam can result in the potentially very dangerous situation of a cartridge discharging before it is properly chambered. If this happens, the cartridge case may rupture and its fragments fly out of the ejection port of the pistol with sufficient force to cause serious injury. Always wear shooting glasses!



HITTING PRIMER CAN BURST CARTRIDGE

To Minimize Malfunctions (“Jams” Or “Misfires”)

1. If it seems that the jam was caused by the type of ammunition used, consider trying another brand, type, or lot number. Remember to only use factory ammunition of the appropriate caliber.
2. If changing ammunition does not immediately resolve malfunctions, follow these steps:
 - a. Thoroughly clean the pistol, paying close attention to removing accumulated grease and dirt. Utilize a bristle brush and solvent to eliminate grease and fouling from the breech-face, extractor, chamber, and feed ramp area immediately behind the chamber.
 - b. Verify that the magazine spring adequately returns the magazine follower to the top of the magazine.
 - c. Inspect the magazine lips to ensure they are free of nicks and burrs and are not deformed or cracked.
 - d. Remove excess oil and solvent from all cleaned components, load the magazine, and test the pistol again. Ensure you follow the correct loading and firing sequence as outlined in this manual.
 - e. If none of the above steps prove effective, attempt using a different magazine from Bersa that is compatible with the M2XI model. If a new magazine fails to function properly, return the pistol and magazines to Bersa.
 - f. Modifications to the pistol or the use of non-Bersa magazines and accessories may lead to malfunctions.

Break-In Period

Break-In Period – The Bersa M2XI are custom firearms, hand lapped, hand fitted, and manufactured with extremely tight tolerances by experienced craftsman. The M2XI firearm requires that you field strip and clean the firearm, following the procedures provided. Please refer to the disassembly, cleaning, and lubrication instructions in this manual. To assist the frame, slide, and barrel lock-up to marry and break-in together, there is a process for properly breaking-in the firearm. The M2XI will need to be fired about 400 to 500 rounds with quality FMJ ammunition, cleaning and lubricating the gun every 100 rounds.

Notice Concerning Some Flat-Nose And Hollow Point Ammunitions

In rare occurrence, the M2XI firearm may not feed some flat nose and some hollow point ammunitions. Bersa has made minor modifications in the historic M2XI Series 70 design to improve the feed success of many flat nose and hollow point ammunitions; still, some aggressive variations of flat nose and hollow point ammunitions can present feed problems. Bersa suggests testing ammunition for proper feeding prior to relying on any ammunition for any situations where steadfast reliability is required.

Disassembly/Reassembly

WARNING: FOR ROUTINE MAINTENANCE, IT IS UNNECESSARY TO DISASSEMBLE THE FIREARM BEYOND WHAT IS DESCRIBED IN THESE INSTRUCTIONS. ANY FURTHER DISASSEMBLY SHOULD BE PERFORMED BY A LICENSED GUNSMITH.

WARNING: WEAR SAFETY GLASSES EVERY TIME YOU ASSEMBLE OR DISASSEMBLE YOUR FIREARM.



WARNING - UNLOADING

Always unload a firearm before cleaning, lubrication, disassembly or assembly.



UNLOAD BEFORE DISASSEMBLY

1. POINT GUN IN A SAFE DIRECTION WHILE KEEPING FINGER OFF THE TRIGGER.
2. Unload the pistol and lock the slide to the rear by retracting the slide and lifting the slide stop lever up into the slide stop notch in the slide.
3. With the slide locked to the rear and using a 5/32 hex wrench, loosen the guide rod 1/2 to 1 full turn counterclockwise but do not completely unscrew the rod. NOTE: The slide is under spring tension so maintain control for the following steps.

4. Align the disassembly notch in the slide with the slide stop and remove the slide stop from the pistol in a right to left motion.

WARNING: THE RECOIL SPRING IS UNDER PRESSURE. YOU MUST CONTROL THE SPRING AND PLUNGER TO PREVENT IT FROM FLYING OUT AND CAUSING INJURY.

5. While maintaining control of the slide, remove the slide assembly from the frame by moving the slide forward and off the frame rails.



6. Unscrew the guide rod section and remove from the slide.
7. Carefully as the guide rod head is under spring tension, lift and remove the guide rod head and recoil spring from the slide and spring plug.
8. Remove the reverse spring plug from its home by sliding it rearward from the recoil spring tunnel in the slide.

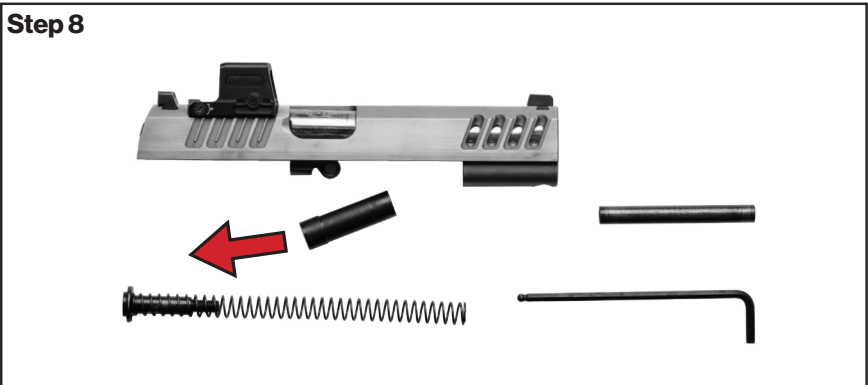

9. Grasp the barrel lug and lift upwards slightly to disengage locking lugs and then slide the barrel forward and out of the slide while maintaining vertical orientation of the barrel lug. Field stripping is now complete.





DO NOT DRY FIRE YOUR M2XI PISTOL WHILE THE SLIDE IS REMOVED. DOING SO CAN RESULT IN DAMAGE TO THE HAMMER OR OTHER INTERNAL PARTS.



DO NOT ALTER, MODIFY OR REPLACE ANY OF THE PARTS OF YOUR FIREARM UNLESS THE MODIFICATION IS PERFORMED BY A QUALIFIED GUNSMITH, USING GENUINE BERSA PARTS. IF YOU DO OTHERWISE, IMPROPER FUNCTION MAY OCCUR AND SERIOUS INJURY MAY RESULT.



NEVER DISASSEMBLE YOUR HANDGUN BEYOND THE FIELD STRIPPING PROCESS OUTLINED IN THIS MANUAL. NEVER MANIPULATE ANY INTERNAL COMPONENTS BEYOND WHAT YOU ARE SPECIFICALLY INSTRUCTED TO DO IN THIS MANUAL SINCE THIS MAY AFFECT THE RELIABILITY, FUNCTIONING AND SAFETY OF YOUR HANDGUN.



OTHER BRAND PARTS MUST NEVER BE USED IN YOUR M2XI EVEN THOUGH THE PARTS MAY APPEAR TO BE SIMILAR. USE OF ANY PARTS OTHER THAN GENUINE BERSA M2XI PARTS MAY CAUSE A SERIOUS MALFUNCTION RESULTING IN INJURY OR DEATH TO YOU OR OTHERS.

This Page Was Intentionally Left Blank

Reassembly

For reassembly, please follow all disassembly instructions in reverse order. Once reassembled, complete function check below before firing pistol.

Check Your Pistol's Function

In order to ensure the safe operation of your pistol, periodic inspection is recommended. Cleaning your pistol is encouraged after all range sessions and exposure to harsh conditions such as moisture and humidity or abrasives such as sand and dirt. Routine maintenance of your pistol can ensure its longevity and help detect early signs of damage and wear to internal parts.

Prior to each use, visually inspection of the firearm is important to make sure there are no missing, loose, bent, cracked or otherwise damaged parts. If excessive wear is detected, immediately stop use of your pistol and contact customer service or a trained, certified gunsmith to evaluate its condition and perform any repairs if necessary.

After disassembly and reassembly, verify that the pistol functions correctly before any live firing is attempted.

Keep pistol unloaded and muzzle pointed in a safe direction at all times during function check.

FIRST, BE SURE THERE IS NO AMMUNITION IN THE CHAMBER OR THE MAGAZINE AND KEEP THE PISTOL POINTED IN A SAFE DIRECTION!

CHECK THE FUNCTION OF THE SLIDE:

- Begin with an unloaded pistol. Pointing the pistol in a safe direction, remove the magazine. Adjust safety to “fire” position. Pull back on slide and lock it with the slide stop. Visually inspect the chamber to ensure there are no rounds chambered.
- Allow the slide to release.
- Insert an empty magazine, ensuring the magazine locks in place and stays locked in.
- Pull back slide again. As the slide moves fully back, the slide stop should engage independently and secure slide in the rear position.

- Remove the empty magazine.
- Pull back slightly on the slide and release. The slide should move forward fully unimpeded.
- Without a magazine, fully pull back on the slide and release. Ensure slide operates smoothly and fully travels forward without stopping.

CHECK THE FUNCTION OF THE TRIGGER:

The Following functions are only to be performed after the firearm is completely unloaded and while keeping the muzzle of the pistol pointed in a safe direction.

- Completely unload pistol, including removal of the magazine, and move the hammer to the “full cock” position. Move safety switch down to the “fire” position. Pointing the pistol in a safe direction, depress the trigger without engaging the grip safety. The hammer should not move.
- Move safety up to the “safe” position, ensuring it is securely fixed in this position. With grip safety engaged, pull the trigger. The hammer should not move.
- With the safety in the “fire” position, and engaging the grip safety, squeeze the trigger. The hammer should fall.
- Keeping the trigger depressed, pull the slide back and release it. After cycling the slide, a soft click will be audible as the trigger resets. The hammer should remain in the “full cock” position as the slide returns to its forward position and should remain up as the trigger is released.
- Pull the trigger again, keeping the muzzle pointed in a safe direction, and the hammer should fall.

If any of the above function checks fail or if you are uncertain, please consult a competent gunsmith or contact Bersa Customer Service at (888) 634-5379 for further firearm inspection before using the firearm.

Magazine Inspection And Care

Inspect the magazine after each use. It is important that the magazine follower provide adequate tension to push up the next round yet be able to move freely. The lips of the magazine should be free of damages to ensure that the rounds are held securely within the magazine in the proper feeding position.

When performing necessary cleaning, use a cleaner that does not rust the metal components or otherwise compromise the magazine body. If soaking the magazine to loosen accumulated dirt and grime, with the loading opening away from you, shake aggressively to remove solution or particulates from the magazine. Be sure to completely dry the magazine out before use as oils and solvents can weaken cartridges which may contribute to misfire, jams, or barrel obstructions.

After cleaning, it is imperative to check the magazine follower for free movement and proper tension. If after cleaning, there are issues with movement or tension, do not attempt to use the magazine and instead replace it with a new Bersa M2XI Magazine.

DAMAGED, NON-STANDARD, OR IMPROPERLY ASSEMBLED MAGAZINES SHOULD NOT BE USED. THEY CAN CAUSE THE PISTOL TO MALFUNCTION.

Care And Cleaning

BEFORE CLEANING, ENSURE THE PISTOL IS COMPLETELY UNLOADED.

Oiling and cleaning of the pistol should be regularly performed, especially when exposed to abrasives or harsh conditions. Routine maintenance helps to maintain the pistol in working and reliable order. To clean the pistol, proceed as follows:

1. Disassemble the pistol following the disassembly instructions from earlier
2. With the use of a cleaning rod, wet a small patch with solvent and move it through the bore several times. Then attach a bristle brush to a cleaning rod, wet it with solvent and run it through the bore until all buildup is cleaned out. Run clean, dry patches through the bore until they come out clean. Buildup within the bore can result in reduced accuracy, and the accumulation of grease within the chamber can lead to issues with proper chambering.

3. Powder residue should be removed from the pistol using a clean patch or bristle brush wet with powder solvent. After using the powder solvent, a dry patch should be used in the bore before lightly oiling another patch and running it through as well. Wipe down the pistol with a dry patch before wiping it all down with a lightly oiled one.
4. NOTE: Your M2XI will ship from the factory already lubricated. After an initial cleaning, re-oiling or lubrication will be needed, as described below. It is important to not lubricate excessively and to remove all excess lubricants. Excessive lubrication will attract buildup and may even congeal when cold, interfering in the safe and reliable function of the pistol.
 - a. Spread a drop of lubricant along the side and lower rails (Note: The lower rail is the part that rides on the frame). Also lubricate the slide recesses and hammer cocking surface beneath the slide.
 - b. Using a light oil, lubricate the disconnecter where it passes through the frame.
5. Before firing, ensure the barrel is free of oil and grease.



WARNING - LUBRICATION



Firing a pistol with oil, grease, or any other material even partially obstructing the bore may result in damage to the pistol and serious injury to the shooter and those nearby. Do not spray or apply lubricants directly on ammunition. If the powder of a cartridge is affected by the lubricant, it may not be ignited, but the primer firing may push the bullet into the bore where it may be lodged.

Firing a subsequent bullet into the obstructed bore may damage the pistol and cause serious injury or death to the shooter and those nearby. Use lubricants properly. You are responsible for the proper care and maintenance of your firearms.



IMPROPER LUBRICATION DESTROYS FIREARMS

Lubrication

To ensure the longevity and optimal performance of your M2XI firearm, it is important to lubricate it after each cleaning. Depending on the frequency of use, periodic lubrication may also be necessary between cleanings.

For the best results, we recommend using a reputable gun oil that comes with a small applicator tip. This will allow you to apply the oil precisely and in small amounts to the appropriate areas.

We suggest applying a small amount of gun oil to the following areas:

- Barrel hood (1 to 2 drops)
- Rails (1 to 2 drops per side)

Please note that it is crucial not to use excessive amounts of gun oil. Over-lubrication can lead to the accumulation of dust and particles, which may eventually cause the pistol to malfunction. If this happens, please refer to the cleaning process outlined in this manual and ensure a thorough cleaning.

Rear Sight Adjustment

WARNING: ALWAYS ENSURE YOUR FIREARM IS UNLOADED BEFORE ADJUSTING YOUR SIGHTS. AT ALL TIMES YOU SHOULD FOLLOW THE BASIC RULES OF SAFE FIREARM HANDLING.

The Bersa M2XI pistols are equipped with a windage adjustable rear-sight only.

To adjust where shots group, loosen the rear sight using an Allen wrench. Move the rear sight in the desired direction the grouping should move. For example, if the group is desired to move to the right, the sight should be moved to the right. Once the desired position is achieved, tighten the sight back.

For moving or adjusting the rear-sight, specialized tools are recommended, which may not be easily accessible to the average firearm owner. Using incorrect tools can result in damage to the firearm or sights. To prevent potential harm to the slide and/or sights, Bersa suggests consulting a qualified gunsmith for any necessary sight adjustments.



WARNING - STORAGE

Never place or store any firearm in such a manner that it may be dislodged. Firearms should always be stored securely and unloaded, away from children and careless adults.



- Use the locking device supplied with the pistol for storage. The use of a locking device or safety lock is only one aspect of responsible firearms storage.

- For increased safety, firearms should be stored unloaded in a location that is both separate from their ammunition and inaccessible to children and any other unauthorized person.



STORE SECURELY & UNLOADED

Storage

FIREARMS SHOULD NOT BE STORED LOADED!

USE THE LOCKING DEVICE SUPPLIED WITH THE PISTOL TO RENDER IT INOPERATIVE FOR SAFE STORAGE.

All firearms should be stored unloaded. Firearms must be stored and secured to prevent access by children and other unauthorized users. Avoid storing your pistol in a holster made of canvas, leather, or any fabrics as these can attract moisture despite appearing dry.

Service And Parts Policy

CAUTION: BEFORE SHIPPING ANY FIREARM, IT IS ABSOLUTELY IMPERATIVE TO ENSURE THAT THE FIREARM AND IT'S MAGAZINE ARE UNLOADED. DO NOT SHIP ANY CARTRIDGES WITH A FIREARM

Shipping Firearms for Repair, Service, or Warranty Claim

NOTE: Prior to returning your firearm, you must acquire a RMA (Repair Authorization) Number. Contact BERSA Customer Service online at Bersausa.com or call the Customer Service Department at (833)476-1547 to obtain an authorization number. The RMA number provided must be written clearly and in a conspicuous location on the outside of the package. Firearms should be sent prepaid. BERSA USA will not accept any collect shipments or packages without an RMA number clearly marked on the package. Any BERSA M2XI pistol sent to the factory for repair should be addressed to: BERSA USA, LLC., Customer Service Department, 100 Industrial Drive, Suite 200, Cartersville, GA 30120. The Federal Gun Control Act, along with the laws of most states and municipalities, do not prohibit an individual (who is not otherwise barred from purchasing or possessing a firearm) from shipping a firearm directly to the manufacturer for repair. However, before shipping your firearm to BERSA, ensure that your state or locality does not have a law or regulation that will prevent you from receiving the firearm (or any included magazines) after it has been repaired. If the return receipt of the firearm is prohibited, please arrange for a federally licensed firearms dealer to ship the firearm to us. If your firearm is sent by a dealer, it will be returned to that dealer after repairs. If a handgun (pistol or revolver) is shipped by an individual who does not hold a Federal Firearms License, it must be shipped for overnight delivery via U.P.S., Federal Express, or similar private overnight service. NOTE: Individuals without a Federal Firearms License are prohibited by Federal law from shipping a handgun via U.S. Mail. Firearms mailed in violation of the law may be impounded or confiscated by the U.S. Postal Service, and the person in violation of the law could be subject to prosecution.

Please refrain from including holsters, custom grip panels, or accessories with a firearm being shipped to BERSA USA for service. Bersa will not be responsible for any such items that are included with the service return.

For your protection, always insure your shipment. Enclose a letter which includes your name, address, telephone number, firearm serial number and model, and your repair authorization number. Describe in detail the trouble you have experienced with your firearm, or the work you wish to have done. Merely stating that the firearm “needs repair” is inadequate information. Please enclose copies of any previous correspondence.

All work performed is subject to a minimum labor charge and charges for shipping and handling. Most models can be reblued, but custom gunsmithing service or nonstandard alterations are NOT AVAILABLE from BERSA Customer Service Departments. Please contact the Customer Service Department for pricing information. In states that have a magazine capacity limitation, DO NOT RETURN so-called “high capacity” magazines as we may not be able to return the magazine to you.

Ordering Parts

Please contact customer service for more information about ordering Bersa certified parts.

WARNING: A firearm containing broken, malfunctioning or badly worn parts should not be fired!

Limited Lifetime Guarantee

BERSA USA, LLC., Cartersville, Georgia, warrants to the original purchaser that this BERSA USA® firearm will be free from defects in material and workmanship under normal use for a duration of one year starting from the purchase date. Under this warranty, BERSA USA® shall repair or replace any defective part, or at their option, exchange the firearm within a reasonable time and without charge. Any claims under this warranty must be made in writing within one year of purchase, accompanied by proof of purchase date and firearm (with insurance and shipping prepaid by the purchaser), and sent to BERSA USA, LLC., Customer Service Department, at 100 Industrial Drive, Suite 200, Cartersville, GA 30120. BERSA USA® will cover return shipment and insurance costs provided the claim falls within the scope of this warranty.

However, this warranty will not apply if the claimed defect or malfunction arises due to neglect, abuse, mishandling, unauthorized adjustments, alterations or modifications, use of improper ammunition, or unreasonable use of the firearm.

This warranty gives you specific legal rights, and you may also have other rights which vary state-to-state. If you require assistance in connection with

this warranty, contact Bersa Customer Service or email them at info@bersausa.com.

If the repair is determined to not be covered by warranty, the charges for repair and return shipment must be paid prior to return shipment.

Notice of Disclaimer of Liability

BERSA USA, LLC., will not be responsible for the results of careless handling, misuse, unauthorized repairs and adjustments, corrosion, neglect, and unreasonable or unsafe use. Bersa assumes no responsibility for damage and/or injury caused in whole or in part by hand loaded, reloaded, steel cased or defective ammunition. Under no circumstances shall Bersa be responsible for incidental or consequential damages with respect to economic loss or injury to property or other grounds, including those arising out of use of handloaded, reloaded, steel cased or defective ammunition, as well as negligence, unsafe handling or unauthorized modifications to the firearm. Some states do not allow the exclusion or limitation of incidental or consequential damages, so the above limitations regarding them may not apply to you.

Lifetime Service Contract

Upon the expiration of the one-year Warranty, and for as long as this BERSA USA® firearm is owned by the original purchaser, BERSA USA® offers to service and repair any defects or malfunction in this BERSA USA® firearm, excluding normal wear, protective finish, grips, sight, or magazine, without charge. Requests for service should be submitted in writing, together with proof of purchase and the firearm (insurance and shipment prepaid by the purchaser), to the authorized service center as identified on the BERSA web site. Return shipment and insurance shall be paid by BERSA USA® provided the service is covered by this service contract.

This service contract is extended only to the original purchaser, is not transferable, and shall be waived if the defect or malfunction was caused by neglect, abuse careless handling, willful damage, damage caused by overpressure ammunition, or unauthorized ammunition, ordinary wear and tear, unreasonable use, or failure to provide reasonable and necessary maintenance as set forth in the instruction manual. Moreover, this agreement will not apply to those parts of your BERSA USA® firearm which have been “tuned” or “gunsmithed” for performance other than customized tuning and other services provided by an authorized service center.

Please visit bersausa.com and register for the firearm warranty to assist us in communication of any important notices and to provide future assistance. If you require assistance in connection with this service contract, please contact our Customer Service Department at (833)476-1547 or email us at info@bersausa.com

NOTICE: It is illegal to ship firearms with ammunition in the firearm or in the same packaging. Firearm and ammunition must be shipped separately. Make sure you are in compliance with all local and federal laws when shipping a firearm for repair under this service contract to any authorized service center. You are solely responsible for understanding and complying with all state, federal, or other applicable laws or regulations regarding the shipment of



WARNING!

If a firearm is carelessly or improperly handled, unintentional discharge could result and could cause injury, death or damage to property. Do not use steel cased ammunition, hand loads, reloads or remanufactured ammunition in your Bersa product. Use of this ammunition is dangerous and by using it you assume all risks associated with its use. The use of steel cased ammunition, hand loads, reloads or remanufactured ammunition will void the Bersa Guarantee.



IMPORTANT!

Before your Bersa complete firearms, complete upper halves, and complete lower halves left the factory, they were tested, carefully inspected and packaged. Bersa cannot control product handling after it leaves the factory. Therefore, please examine the product carefully at the time of purchase to insure that it is unloaded and undamaged.

Rules for Safe Operation

1. Always keep firearm pointing in a safe direction at all times.
2. Finger should always remain off the trigger until ready to fire.
3. Firearm should always be stored and transported unloaded.
4. Always assume all firearms are loaded until it can be safely and properly checked.
5. Always identify your target and any dangers or unsafe condition beyond it.
6. Always store firearms and ammunition in a locked and inaccessible location to children.



M2XI

FROM BERSA USA

